



7 Church View, ,
Hereford HR4 7BX

£1,450 Per Calendar Month

TO LET



PROPERTY SUMMARY

A beautifully presented detached house, forming part of a select modern development on the outskirts of this small rural village. The property comprises a large sitting room with patio doors to the rear gardens, a wood-burner and oak flooring, Kitchen/breakfast room with integrated appliances, rear hall with pantry cupboard and separate cloakroom a staircase leads up to a first-floor landing and to a master bedroom with an ensuite shower room. There are three other bedrooms, two further double and one smaller bedroom, currently used as a dressing room. To the outside there is a driveway with parking for four cars and leads to the former garage. The detached garage has been fully insulated and divided to create a workshop, with power and lighting, which is accessed through insulated, security double-doors. To the rear of the converted garage is a separate utility room, with shelving and further base units, sink and space for plumbing. The gardens are low maintenance and include a enclosed vegetable section with raised beds.

NOTES & COMMENTS

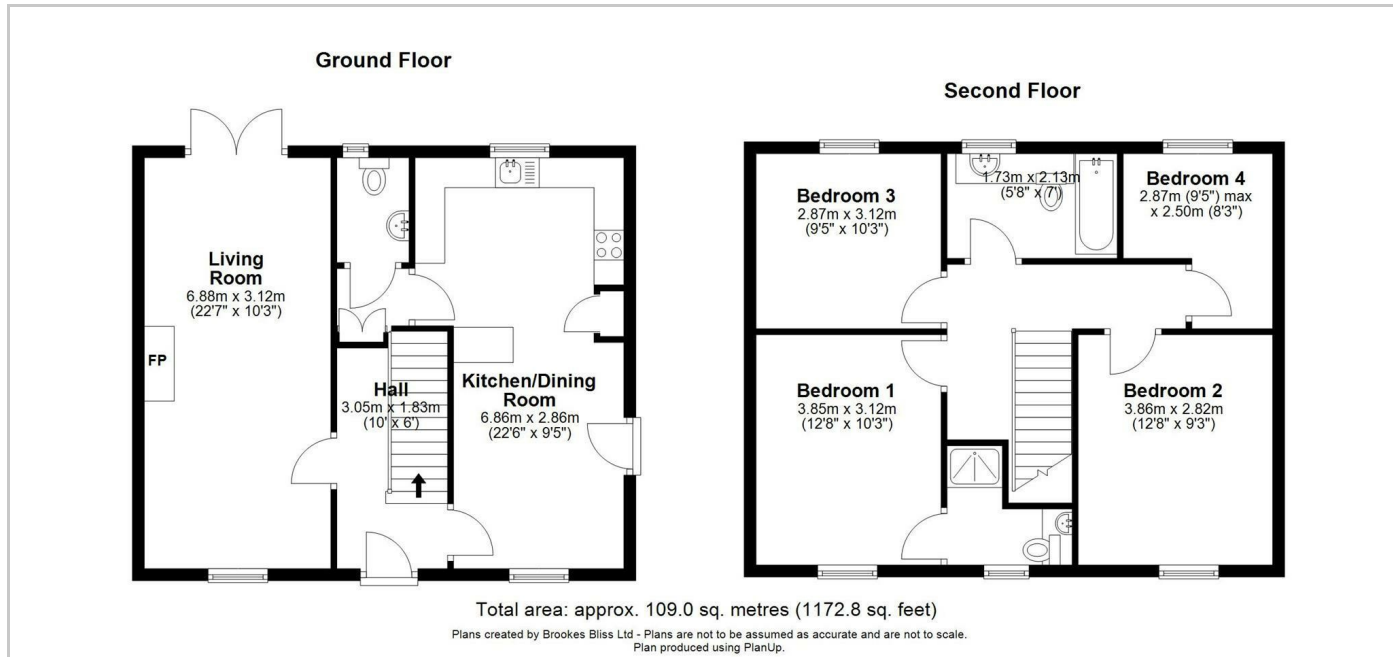

DIRECTIONS

FEES

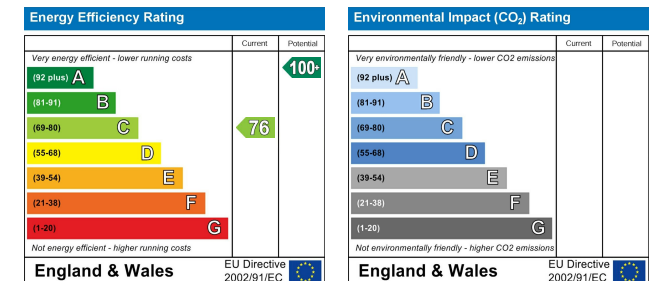

Brookes Bliss

These particulars are offered on the understanding that all negotiations are conducted through this company. Neither these particulars, nor oral representations, form part of any offer or contract, and their accuracy cannot be guaranteed.

46 Bridge Street, Hereford, Herefordshire HR4 9DG
Tel: 01432 343800
Lettings@brookes.bliss.co.uk

brookesbliss.co.uk

rightmove